



PLAN DRAWINGS

RECOMMENDED ASSEMBLIES

CONTACTS

ROMEX® Canada
260 Riverside Drive, North Vancouver,
BC. V7H 2M2

info@romexcanada.com
www.romexcanada.com
Hotline 1-604-913-1579

ROMEX®
■ PERMEABLE HARDSCAPES





ROMEX® SYSTEM GUARANTEE

The ROMEX® SYSTEM GUARANTEE is a competitive advantage for any customer. ROMEX® is the first and only manufacturer in the field of paving stone and slab construction to offer such a warranty to its customers. ROMEX® means security and peace of mind, which is especially important for companies who today must often provide a multi-year warranty on their construction services to their clients.

With the ROMEX® SYSTEM GUARANTEE, or 'RSG' for short, ROMEX® is the first manufacturer of paver bedding and jointing systems to offer installation companies peace of mind and a competitive advantage in the industry.

i Talk to us about the guarantee conditions!



	
	ROMEX® SYSTEM GUARANTEE for the ROMEX® SYSTEM <input type="checkbox"/> BONDED-1-PRIVATE Use category N1 <input type="checkbox"/> BONDED-1-PRIVATE Use category N2 / N3
<i>Certificate</i>	Recipient of guarantee <small>(According to selected company)</small> Company: _____ Surname: _____ Street: _____ Postcode / town: _____ Country: _____
	Construction site: Designation: _____ Address: _____ Street: _____ Postcode / town: _____ Country: _____
The guarantee terms outlined apply. Place / date: _____ Signature / stamp: _____	

ROMEX® RSG PERMEABLE PAVING SYSTEM ON UNINSULATED ROOF - LIGHT VEHICLE LOADING

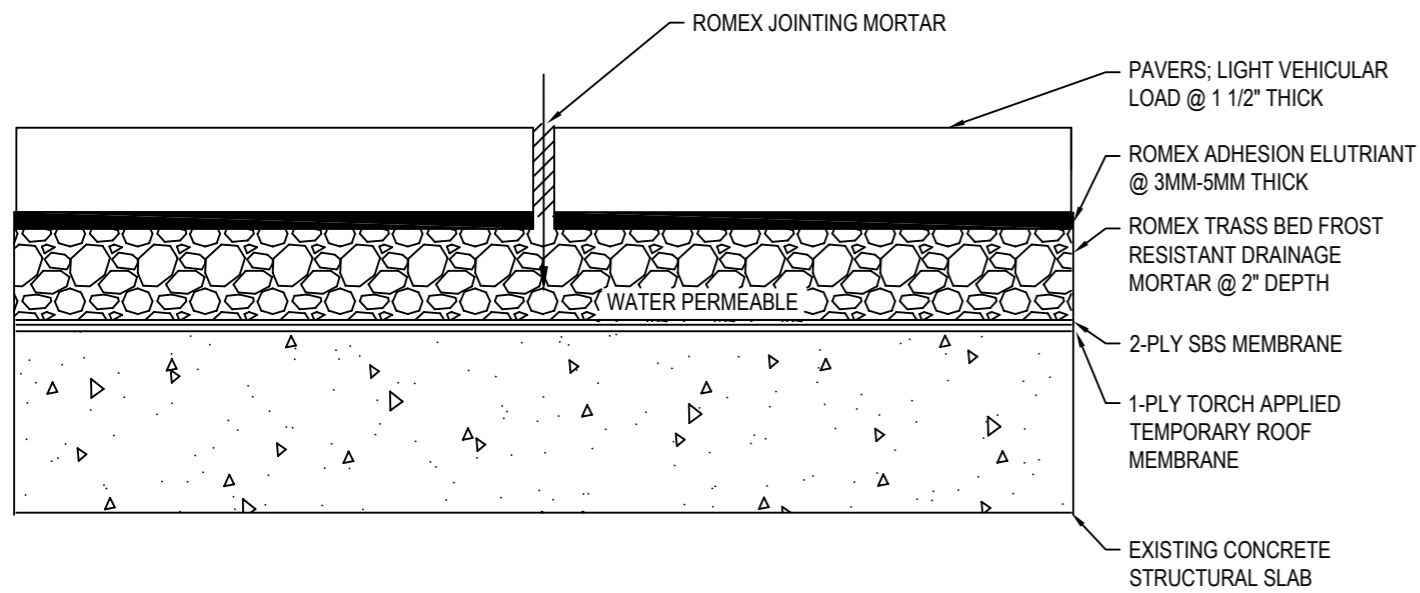

ROMEX® - ADHESION ELUTRIANT:

MIXING: TO ACHIEVE A CONSISTENCY THAT IS PLASTIC AND CAN BE SPREAD, POUR 8.5 LITRES OF COOL, CLEAN WATER INTO A CONTAINER. THEN ADD 25 KG OF ROMEX® - ADHESION ELUTRIANT AND STIR FOR 3 MINUTES. AFTER 3 MINUTES OF MATURING TIME STIR THROUGH AGAIN BRIEFLY. ALWAYS USE THE ENTIRE CONTAINER.

APPLICATION: APPLIED TO THE SLAB UNDERSIDE WITH A LAYER THICKNESS OF APPROX. 3-5MM OR DIP THE SLAB 2-3 CM DEEP INTO THE TUB OF ROMEX® - ADHESION ELUTRIANT.

STORAGE LIFE: 6 MONTHS OF STORAGE LIFE (DRY IN ORIGINAL, SEALED SACK).

ROMEX® - TRASS BED

MIXING: MIX ROMEX® - TRASS BED COMPOUND IN A RATIO OF 1 TO 4 WITH FILLER MATERIAL (I.E ROLLED GRIT / GRAVEL) 4-8 MM SO THAT IT IS EARTH DAMP, MIXING TIME 2-3 MINUTES. WATER REQUIREMENTS APPROX 9% (3.6-3.8 LITRES) OF COOL, CLEAN WATER PER 40 KGS OF READY TO USE MIXTURE. IMPORTANT TO ADD WATER TO THE MIXER FIRST, THEN THE MORTAR.

APPLICATION: NATURAL PAVING STONES SHOULD BE 3-6 CM DEPENDING ON TYPE OF STONE AND EXPECTED LOADS. WHEN FILLING THE JOINTS, AT LEAST 3 CM JOINT DEPTH FROM THE TOP OF THE STONE IS REQUIRED, IN CASE OF TRAFFIC LOADS AT LEAST 2/3 OF THE HEIGHT. NATURAL AND CONCRETE STONE SLABS SHOULD BE TREATED WITH ROMEX® - ADHESION ELUTRIANT BEFORE LAYING.

STORAGE LIFE: 6 MONTHS OF STORAGE LIFE (DRY IN ORIGINAL, SEALED SACK).

NOTES:

1. INSTALLATION TO BE COMPLETED IN ACCORDANCE WITH MANUFACTURER'S SPECIFICATIONS.
2. DO NOT SCALE DRAWING.
3. THIS DRAWING IS INTENDED FOR USE BY ARCHITECTS, ENGINEERS, CONTRACTORS, CONSULTANTS AND DESIGN PROFESSIONALS FOR PLANNING PURPOSES ONLY. THIS DRAWING MAY NOT BE USED FOR CONSTRUCTION.
4. ALL INFORMATION CONTAINED HEREIN WAS CURRENT AT THE TIME OF DEVELOPMENT BUT MUST BE REVIEWED AND APPROVED BY THE PRODUCT MANUFACTURER TO BE CONSIDERED ACCURATE.
5. CONTRACTOR'S NOTE: FOR PRODUCT AND COMPANY INFORMATION VISIT www.CADdetails.com/info AND ENTER REFERENCE NUMBER 5315-004

ROMEX® RSG PERMEABLE PAVING SYSTEM ON INSULATED ROOF - VEHICLE LOADING

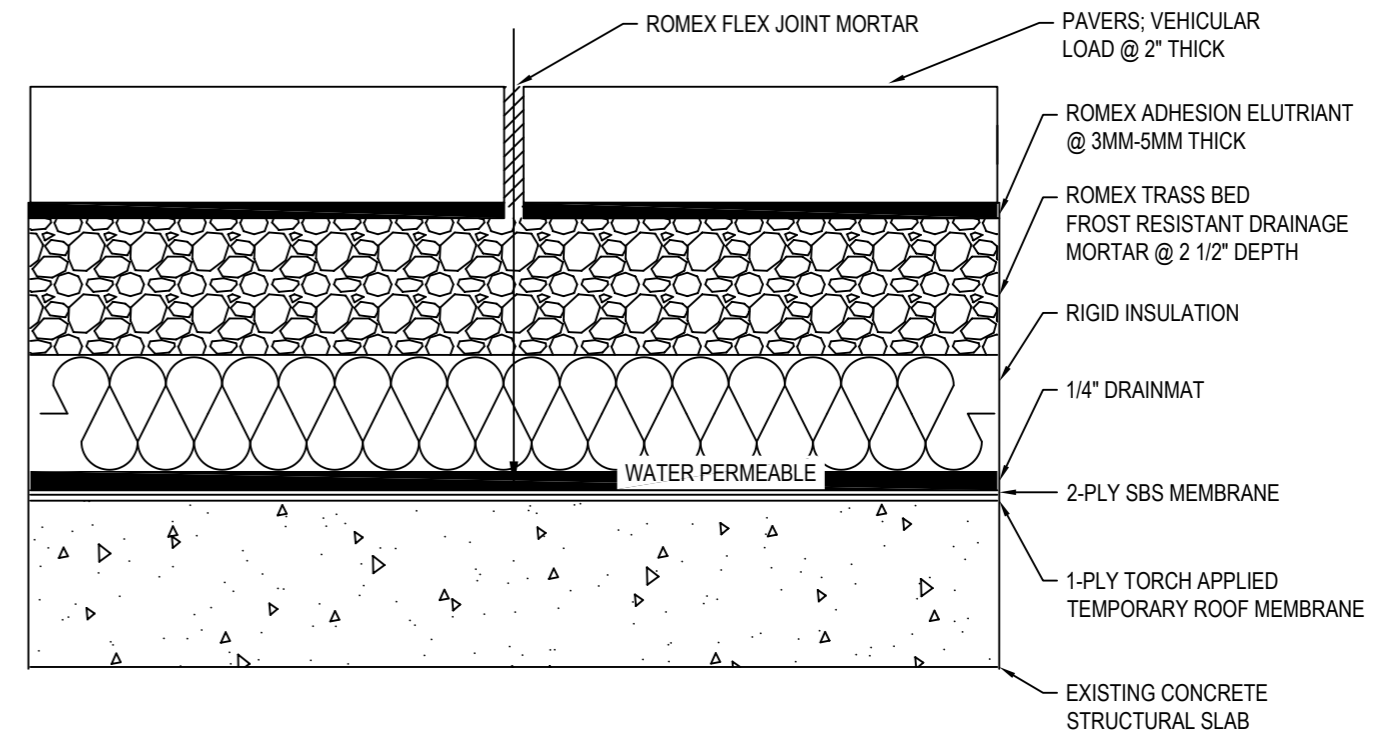

ROMEX® - ADHESION ELUTRIANT:

MIXING: TO ACHIEVE A CONSISTENCY THAT IS PLASTIC AND CAN BE SPREAD, POUR 8.5 LITRES OF COOL, CLEAN WATER INTO A CONTAINER. THEN ADD 25KG OF ROMEX® - ADHESION ELUTRIANT AND STIR FOR 3 MINUTES. AFTER 3 MINUTES OF MATURING TIME STIR THROUGH AGAIN BRIEFLY. ALWAYS USE THE ENTIRE CONTAINER.

APPLICATION: APPLIED TO THE SLAB UNDERSIDE WITH A LAYER THICKNESS OF APPROX. 3-5 MM OR DIP THE SLAB 2-3 CM DEEP INTO THE TUB OF ROMEX® - ADHESION ELUTRIANT.

STORAGE LIFE: 6 MONTHS OF STORAGE LIFE (DRY IN ORIGINAL, SEALED SACK).

ROMEX® - TRASS BED

MIXING: MIX ROMEX® - TRASS BED COMPOUND IN A RATIO OF 1 TO 4 WITH FILLER MATERIAL (I.E ROLLED GRIT / GRAVEL) 4-8 MM SO THAT IT IS EARTH DAMP, MIXING TIME 2-3 MINUTES. WATER REQUIREMENTS APPROX 9% (3.6-3.8 LITRES) OF COOL, CLEAN WATER PER 40 KGS OF READY TO USE MIXTURE. IMPORTANT TO ADD WATER TO THE MIXER FIRST, THEN THE MORTAR.

APPLICATION: NATURAL PAVING STONES SHOULD BE 3-6CM DEPENDING ON TYPE OF STONE AND EXPECTED LOADS. WHEN FILLING THE JOINTS, AT LEAST 3 CM JOINT DEPTH FROM THE TOP OF THE STONE IS REQUIRED, IN CASE OF TRAFFIC LOADS AT LEAST 2/3 OF THE HEIGHT. NATURAL AND CONCRETE STONE SLABS SHOULD BE TREATED WITH ROMEX® - ADHESION ELUTRIANT BEFORE LAYING.

STORAGE LIFE: 6 MONTHS OF STORAGE LIFE (DRY IN ORIGINAL, SEALED SACK).

NOTES:

1. INSTALLATION TO BE COMPLETED IN ACCORDANCE WITH MANUFACTURER'S SPECIFICATIONS.
2. DO NOT SCALE DRAWING.
3. THIS DRAWING IS INTENDED FOR USE BY ARCHITECTS, ENGINEERS, CONTRACTORS, CONSULTANTS AND DESIGN PROFESSIONALS FOR PLANNING PURPOSES ONLY. THIS DRAWING MAY NOT BE USED FOR CONSTRUCTION.
4. ALL INFORMATION CONTAINED HEREIN WAS CURRENT AT THE TIME OF DEVELOPMENT BUT MUST BE REVIEWED AND APPROVED BY THE PRODUCT MANUFACTURER TO BE CONSIDERED ACCURATE.
5. CONTRACTOR'S NOTE: FOR PRODUCT AND COMPANY INFORMATION VISIT www.CADdetails.com/info AND ENTER REFERENCE NUMBER 5315-004

ROMEX® JOINTING MORTAR

WITH OPTIONAL ADHESION ELUTRIANT ON GRADE - PEDESTRIAN (UNBOUND)

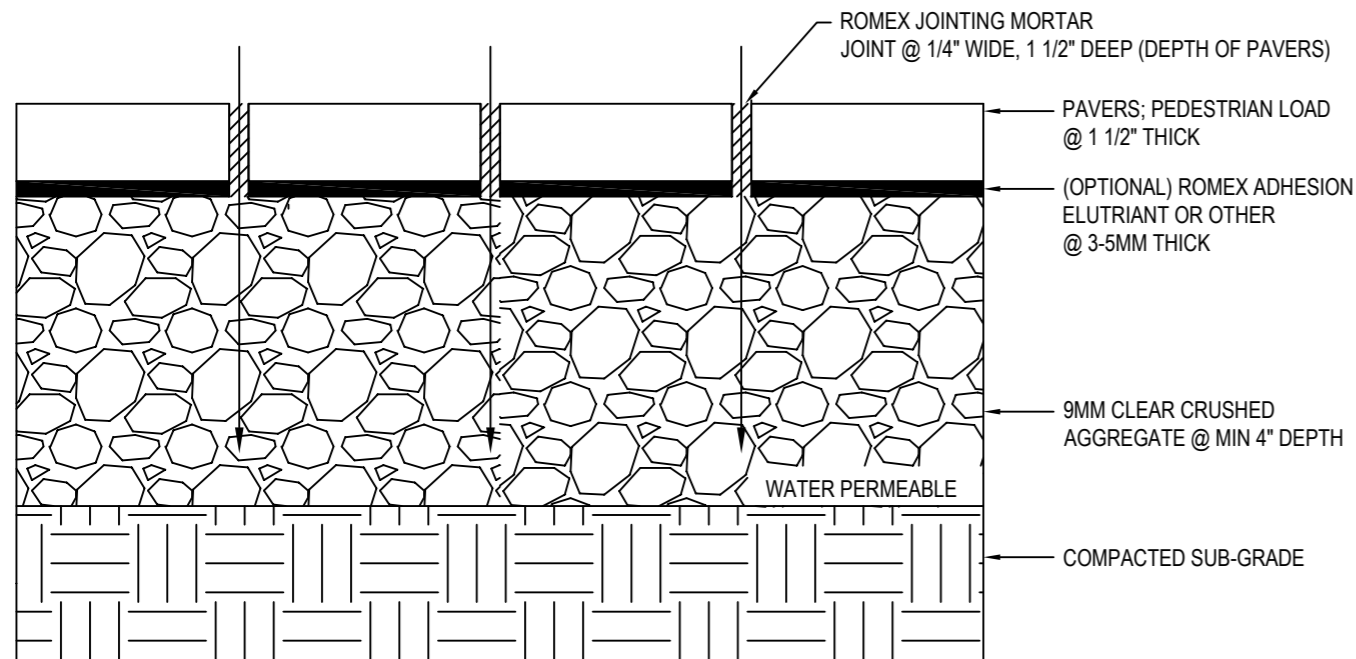

ROMEX® - ADHESION ELUTRIANT (OPTIONAL):

MIXING: TO ACHIEVE A CONSISTENCY THAT IS PLASTIC AND CAN BE SPREAD, POUR 8.5 LITRES OF COOL, CLEAN WATER INTO A CONTAINER. THEN ADD 25 KG OF ROMEX® - ADHESION ELUTRIANT AND STIR FOR 3 MINUTES. AFTER 3 MINUTES OF MATURING TIME STIR THROUGH AGAIN BRIEFLY. ALWAYS USE THE ENTIRE CONTAINER.

APPLICATION: APPLIED TO THE SLAB UNDERSIDE WITH A LAYER THICKNESS OF APPROX. 3-5 MM OR DIP THE SLAB 2-3CM DEEP INTO THE TUB OF ROMEX® - ADHESION ELUTRIANT.

STORAGE LIFE: 6 MONTHS OF STORAGE LIFE (DRY IN ORIGINAL, SEALED SACK).

ROMEX® - JOINTING MORTAR

PREPARATION: CLEAN OUT JOINTS TO A DEPTH OF AT LEAST 30 MM (MINIMUM JOINT WIDTH 5 MM). THE SURFACE TO BE JOINTED SHOULD BE CLEANED OUT OF ALL KINDS OF DIRT. ANY ADJOINING SURFACES THAT ARE NOT TO BE JOINTED SHOULD BE TAPED OFF.

STORAGE LIFE: 12-24 MONTHS

*PLEASE SEE MANUFACTURER'S PRODUCT DATA SHEET FOR COMPLETE INFORMATION (VARIES BETWEEN JOINTING MORTAR).

NOTES:

1. INSTALLATION TO BE COMPLETED IN ACCORDANCE WITH MANUFACTURER'S SPECIFICATIONS.
2. DO NOT SCALE DRAWING.
3. THIS DRAWING IS INTENDED FOR USE BY ARCHITECTS, ENGINEERS, CONTRACTORS, CONSULTANTS AND DESIGN PROFESSIONALS FOR PLANNING PURPOSES ONLY. THIS DRAWING MAY NOT BE USED FOR CONSTRUCTION.
4. ALL INFORMATION CONTAINED HEREIN WAS CURRENT AT THE TIME OF DEVELOPMENT BUT MUST BE REVIEWED AND APPROVED BY THE PRODUCT MANUFACTURER TO BE CONSIDERED ACCURATE.
5. CONTRACTOR'S NOTE: FOR PRODUCT AND COMPANY INFORMATION VISIT www.CADdetails.com/info AND ENTER REFERENCE NUMBER 5315-004

ROMEX® FLEX JOINT MORTAR AND ISATEC® ANCHORS

ON GRADE - VEHICULAR (UNBOUND)

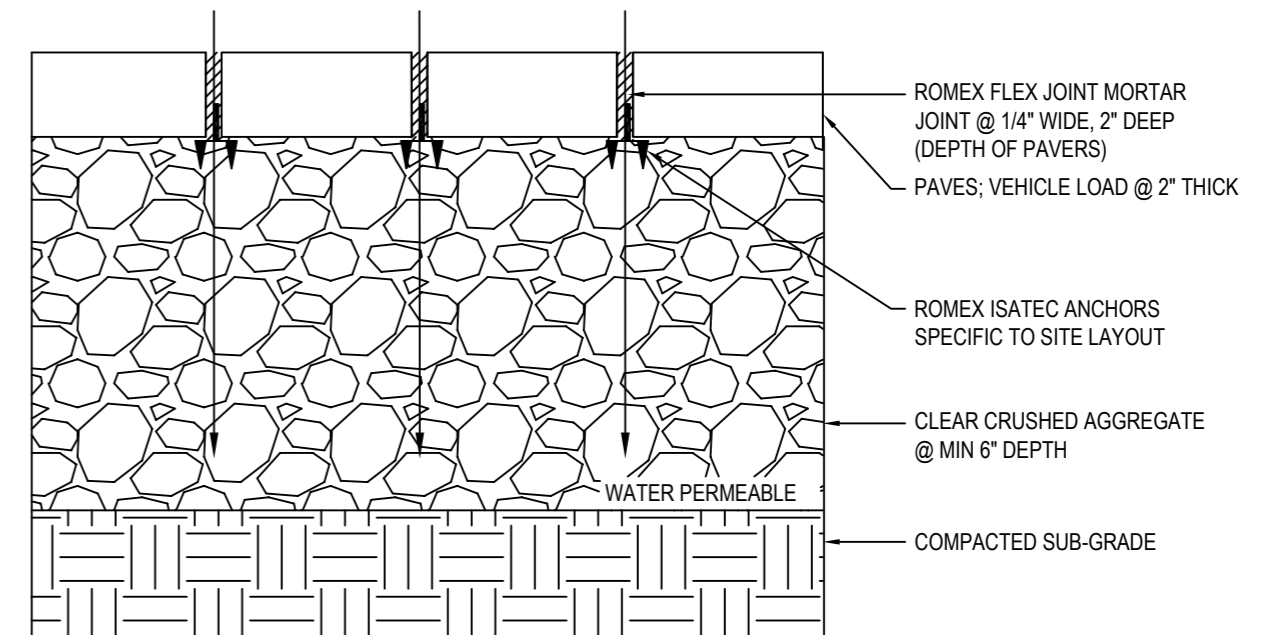

ROMEX® - FLEX JOINT:

PREPARATION: CLEAN OUT JOINTS TO A DEPTH OF AT LEAST 30 MM (MINIMUM JOINT WIDTH 5 MM). THE SURFACE TO BE JOINTED SHOULD BE CLEANED OUT OF ALL KINDS OF DIRT. ANY ADJOINING SURFACES THAT ARE NOT TO BE JOINTED SHOULD BE TAPED OFF.

MIXING: OPEN BUCKET, OPEN BOTTLES WITHIN AND POUR THE CONTENTS SLOWLY AND COMPLETELY INTO THE FILLER MATERIAL COMPONENT. START THE MIXING PROCESS. DO NOT ADD WATER!
TOTAL MIXING TIME: AT LEAST 6 MINUTES.

APPLICATION: APPLY THE MIXED PAVED JOINTING MORTAR ONTO THE WELL DAMP SURFACE AND WORK IT CAREFULLY INTO THE JOINTS. IN ORDER TO USE THE OPTIMUM FLOW CAPACITY OF THE PAVING JOINT MORTAR, IT IS Poured ONTO 3 TO 4 AREAS OF THE JOINTING AREA.

ROMEX® - ISATEC ANCHORS

- ANCHORS ARE, HOT GALVANIZED, SPECIAL ALLOY, OIL HARDENED, RAL COLOURS AND STUDED FORM.
- ANCHORS HAVE BEEN DEVELOPED FOR EACH TYPE OF DRIVING DYNAMIC LOAD TO ENSURE THE REDUCTION OF FUTURE DAMAGE TO SURFACES.

*PLEASE SEE MANUFACTURER'S PRODUCT DATA SHEET FOR COMPLETE INFORMATION.

NOTES:

1. INSTALLATION TO BE COMPLETED IN ACCORDANCE WITH MANUFACTURER'S SPECIFICATIONS.
2. DO NOT SCALE DRAWING.
3. THIS DRAWING IS INTENDED FOR USE BY ARCHITECTS, ENGINEERS, CONTRACTORS, CONSULTANTS AND DESIGN PROFESSIONALS FOR PLANNING PURPOSES ONLY. THIS DRAWING MAY NOT BE USED FOR CONSTRUCTION.
4. ALL INFORMATION CONTAINED HEREIN WAS CURRENT AT THE TIME OF DEVELOPMENT BUT MUST BE REVIEWED AND APPROVED BY THE PRODUCT MANUFACTURER TO BE CONSIDERED ACCURATE.
5. CONTRACTOR'S NOTE: FOR PRODUCT AND COMPANY INFORMATION VISIT www.CADdetails.com/info AND ENTER REFERENCE NUMBER 5315-004

ROMEX® FLEX JOINT MORTAR, ISATEC® ANCHORS

OVER INBITEX PERMEABLE PAVING (UNBOUND)

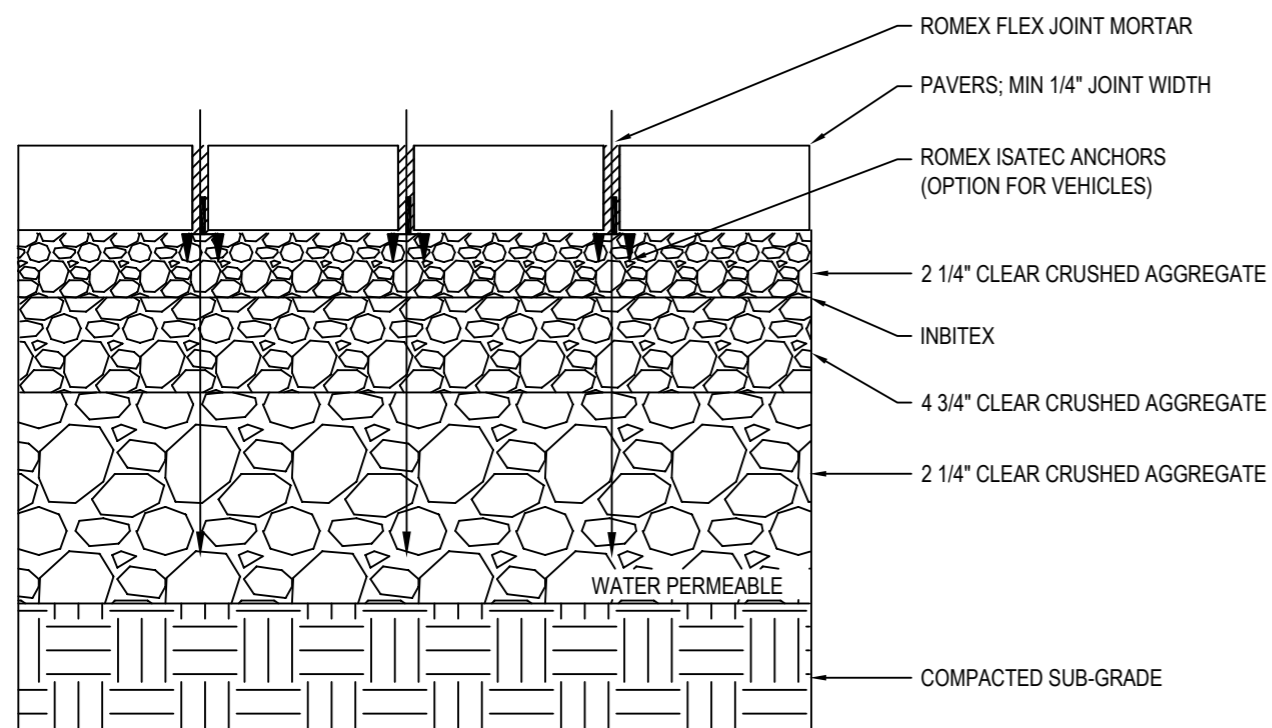

ROMPOX® - FLEX JOINT:

PREPARATION: CLEAN OUT JOINTS TO A DEPTH OF AT LEAST 30 MM (MINIMUM JOINT WIDTH 5 MM). THE SURFACE TO BE JOINTED SHOULD BE CLEANED OUT OF ALL KINDS OF DIRT. ANY ADJOINING SURFACES THAT ARE NOT TO BE JOINTED SHOULD BE TAPED OFF.

MIXING: OPEN BUCKET, OPEN BOTTLES WITHIN AND POUR THE CONTENTS SLOWLY AND COMPLETELY INTO THE FILLER MATERIAL COMPONENT. START THE MIXING PROCESS. DO NOT ADD WATER!
TOTAL MIXING TIME: AT LEAST 6 MINUTES.

APPLICATION: APPLY THE MIXED PAVED JOINTING MORTAR ONTO THE WELL DAMP SURFACE AND WORK IT CAREFULLY INTO THE JOINTS. IN ORDER TO USE THE OPTIMUM FLOW CAPACITY OF THE PAVING JOINT MORTAR, IT IS Poured ONTO 3 TO 4 AREAS OF THE JOINTING AREA.

ROMEX® - ISATEC ANCHORS

- ANCHORS ARE, HOT GALVANIZED, SPECIAL ALLOY, OIL HARDENED, RAL COLOURS AND STUDDED FORM.
- ANCHORS HAVE BEEN DEVELOPED FOR EACH TYPE OF DRIVING DYNAMIC LOAD TO ENSURE THE REDUCTION OF FUTURE DAMAGE TO SURFACES.

*PLEASE SEE MANUFACTURER'S PRODUCT DATA SHEET FOR COMPLETE INFORMATION.

NOTES:

1. INSTALLATION TO BE COMPLETED IN ACCORDANCE WITH MANUFACTURER'S SPECIFICATIONS.
2. DO NOT SCALE DRAWING.
3. THIS DRAWING IS INTENDED FOR USE BY ARCHITECTS, ENGINEERS, CONTRACTORS, CONSULTANTS AND DESIGN PROFESSIONALS FOR PLANNING PURPOSES ONLY. THIS DRAWING MAY NOT BE USED FOR CONSTRUCTION.
4. ALL INFORMATION CONTAINED HEREIN WAS CURRENT AT THE TIME OF DEVELOPMENT BUT MUST BE REVIEWED AND APPROVED BY THE PRODUCT MANUFACTURER TO BE CONSIDERED ACCURATE.
5. CONTRACTOR'S NOTE: FOR PRODUCT AND COMPANY INFORMATION VISIT www.CADdetails.com/info AND ENTER REFERENCE NUMBER 5315-004

ROMEX® JOINTING MORTAR, ADHESION ELUTRIANT

OVER INBITEX PERMEABLE PAVING (BOUND)

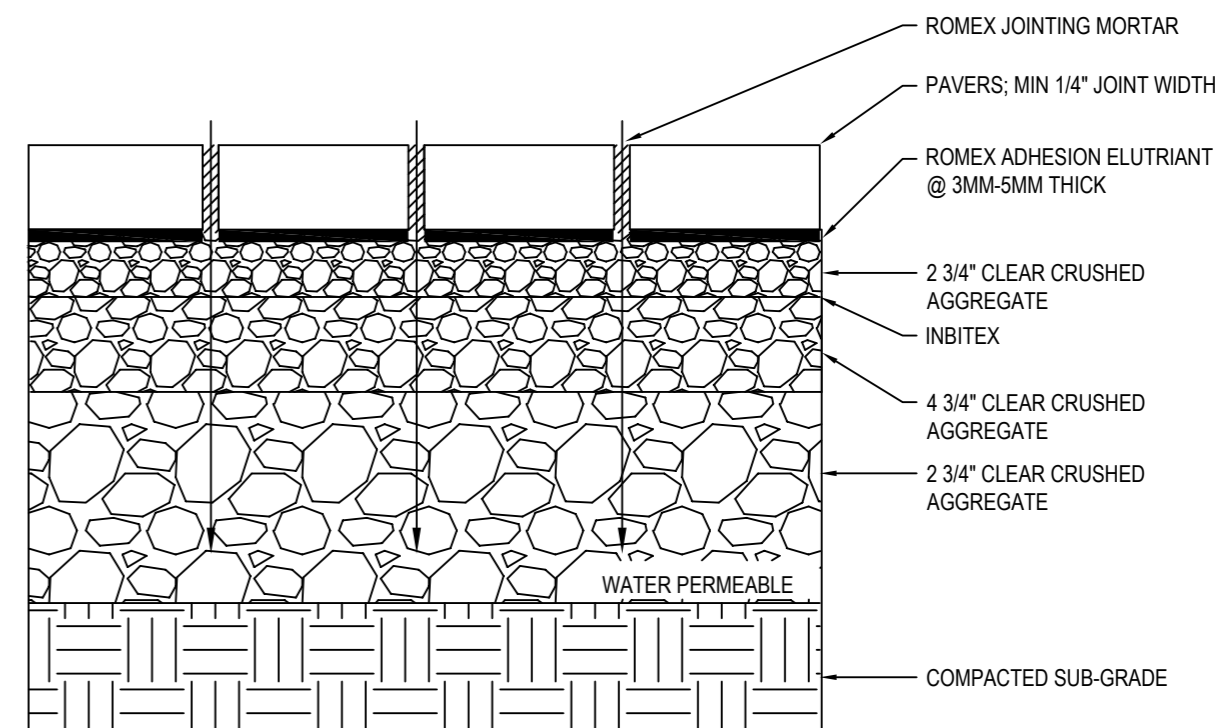

ROMEX® - ADHESION ELUTRIANT

MIXING: TO ACHIEVE A CONSISTENCY THAT IS PLASTIC AND CAN BE SPREAD, POUR 8.5 LITRES OF COOL, CLEAN WATER INTO A CONTAINER. THEN ADD 25 KG OF ROMEX® - ADHESION ELUTRIANT AND STIR FOR 3 MINUTES. AFTER 3 MINUTES OF MATURING TIME STIR THROUGH AGAIN BRIEFLY. ALWAYS USE THE ENTIRE CONTAINER.

APPLICATION: APPLIED TO THE SLAB UNDERSIDE WITH A LAYER THICKNESS OF APPROX. 3-5 MM OR DIP THE SLAB 2-3 CM DEEP INTO THE TUB OF ROMEX® - ADHESION ELUTRIANT.

STORAGE LIFE: 6 MONTHS OF STORAGE LIFE (DRY IN ORIGINAL, SEALED SACK).

ROMEX® - JOINTING MORTAR

PREPARATION: CLEAN OUT JOINTS TO A DEPTH OF AT LEAST 30 MM (MINIMUM JOINT WIDTH 5 MM). THE SURFACE TO BE JOINTED SHOULD BE CLEANED OUT OF ALL KINDS OF DIRT. ANY ADJOINING SURFACES THAT ARE NOT TO BE JOINTED SHOULD BE TAPED OFF.

STORAGE LIFE: 12-24 MONTHS

*PLEASE SEE MANUFACTURER'S PRODUCT DATA SHEET FOR COMPLETE INFORMATION (VARIES BETWEEN JOINTING MORTAR).

NOTES:

1. INSTALLATION TO BE COMPLETED IN ACCORDANCE WITH MANUFACTURER'S SPECIFICATIONS.
2. DO NOT SCALE DRAWING.
3. THIS DRAWING IS INTENDED FOR USE BY ARCHITECTS, ENGINEERS, CONTRACTORS, CONSULTANTS AND DESIGN PROFESSIONALS FOR PLANNING PURPOSES ONLY. THIS DRAWING MAY NOT BE USED FOR CONSTRUCTION.
4. ALL INFORMATION CONTAINED HEREIN WAS CURRENT AT THE TIME OF DEVELOPMENT BUT MUST BE REVIEWED AND APPROVED BY THE PRODUCT MANUFACTURER TO BE CONSIDERED ACCURATE.
5. CONTRACTOR'S NOTE: FOR PRODUCT AND COMPANY INFORMATION VISIT www.CADdetails.com/info AND ENTER REFERENCE NUMBER 5315-004

ROMEX® DEKO GRAVEL PATH

WITH OPTIONAL EDGE RESTRAINT ON GRANULAR BASE

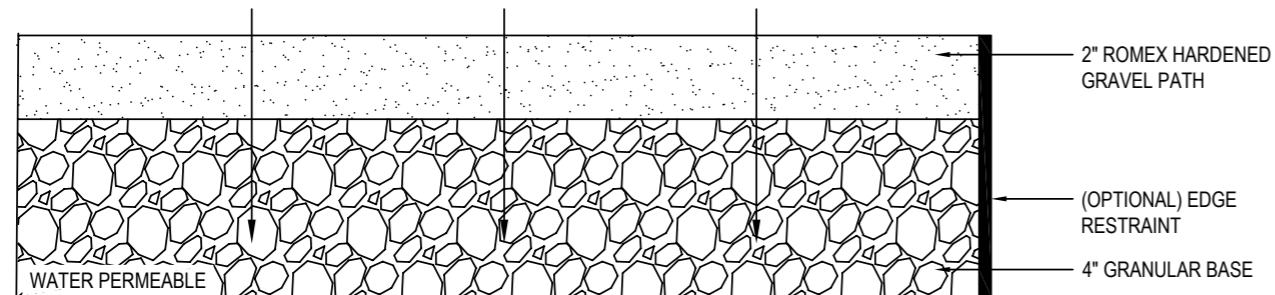

ROMEX® RSG PERMEABLE PAVING SYSTEM

ON GRADE - PEDESTRIAN (BOUND, RSG)

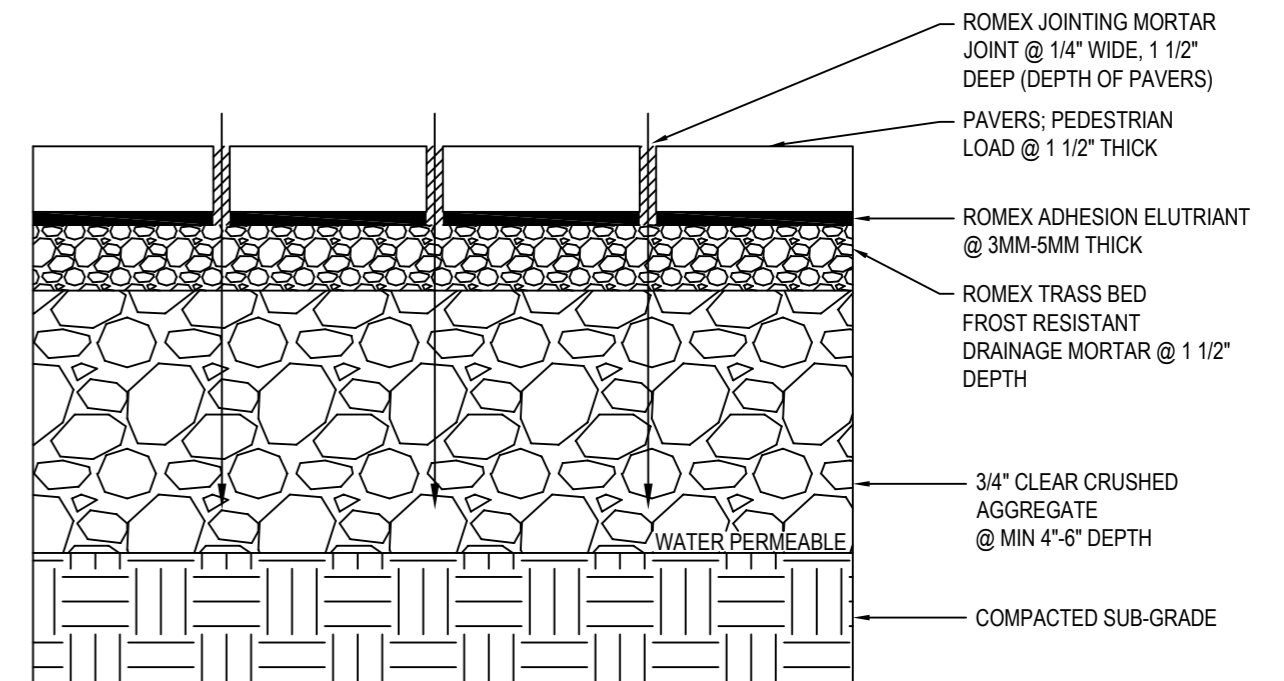

ROMEX® - ADHESION ELUTRIANT:

MIXING: TO ACHIEVE A CONSISTENCY THAT IS PLASTIC AND CAN BE SPREAD, POUR 8.5 LITRES OF COOL, CLEAN WATER INTO A CONTAINER. THEN ADD 25 KG OF ROMEX® - ADHESION ELUTRIANT AND STIR FOR 3 MINUTES. AFTER 3 MINUTES OF MATURING TIME STIR THROUGH AGAIN BRIEFLY. ALWAYS USE THE ENTIRE CONTAINER.

APPLICATION: APPLIED TO THE SLAB UNDERSIDE WITH A LAYER THICKNESS OF APPROX. 3-5 MM OR DIP THE SLAB 2-3 CM DEEP INTO THE TUB OF ROMEX® - ADHESION ELUTRIANT.

STORAGE LIFE: 6 MONTHS OF STORAGE LIFE (DRY IN ORIGINAL, SEALED SACK).

ROMEX® - TRASS BED

MIXING: MIX ROMEX® - TRASS BED COMPOUND IN A RATIO OF 1 TO 4 WITH FILLER MATERIAL (I.E ROLLED GRIT / GRAVEL) 4-8 MM SO THAT IT IS EARTH DAMP, MIXING TIME 2-3 MINUTES. WATER REQUIREMENTS APPROX 9% (3.6-3.8 LITRES) OF COOL, CLEAN WATER PER 40 KGS OF READY TO USE MIXTURE. IMPORTANT TO ADD WATER TO THE MIXER FIRST, THEN THE MORTAR.

APPLICATION: NATURAL PAVING STONES SHOULD BE 3-6CM DEPENDING ON TYPE OF STONE AND EXPECTED LOADS. WHEN FILLING THE JOINTS, AT LEAST 3 CM JOINT DEPTH FROM THE TOP OF THE STONE IS REQUIRED, IN CASE OF TRAFFIC LOADS AT LEAST 2/3 OF THE HEIGHT. NATURAL AND CONCRETE STONE SLABS SHOULD BE TREATED WITH ROMEX® - ADHESION ELUTRIANT BEFORE LAYING.

STORAGE LIFE: 6 MONTHS OF STORAGE LIFE (DRY IN ORIGINAL, SEALED SACK).

NOTES:

1. INSTALLATION TO BE COMPLETED IN ACCORDANCE WITH MANUFACTURER'S SPECIFICATIONS.
2. DO NOT SCALE DRAWING.
3. THIS DRAWING IS INTENDED FOR USE BY ARCHITECTS, ENGINEERS, CONTRACTORS, CONSULTANTS AND DESIGN PROFESSIONALS FOR PLANNING PURPOSES ONLY. THIS DRAWING MAY NOT BE USED FOR CONSTRUCTION.
4. ALL INFORMATION CONTAINED HEREIN WAS CURRENT AT THE TIME OF DEVELOPMENT BUT MUST BE REVIEWED AND APPROVED BY THE PRODUCT MANUFACTURER TO BE CONSIDERED ACCURATE.
5. CONTRACTOR'S NOTE: FOR PRODUCT AND COMPANY INFORMATION VISIT www.CADdetails.com/info AND ENTER REFERENCE NUMBER 5315-004

NOTES:

1. INSTALLATION TO BE COMPLETED IN ACCORDANCE WITH MANUFACTURER'S SPECIFICATIONS.
2. DO NOT SCALE DRAWING.
3. THIS DRAWING IS INTENDED FOR USE BY ARCHITECTS, ENGINEERS, CONTRACTORS, CONSULTANTS AND DESIGN PROFESSIONALS FOR PLANNING PURPOSES ONLY. THIS DRAWING MAY NOT BE USED FOR CONSTRUCTION.
4. ALL INFORMATION CONTAINED HEREIN WAS CURRENT AT THE TIME OF DEVELOPMENT BUT MUST BE REVIEWED AND APPROVED BY THE PRODUCT MANUFACTURER TO BE CONSIDERED ACCURATE.
5. CONTRACTOR'S NOTE: FOR PRODUCT AND COMPANY INFORMATION VISIT www.CADdetails.com/info AND ENTER REFERENCE NUMBER 5315-004

ROMEX® RSG PERMEABLE PAVING SYSTEM

ON GRADE - VEHICULAR (BOUND, RSG)

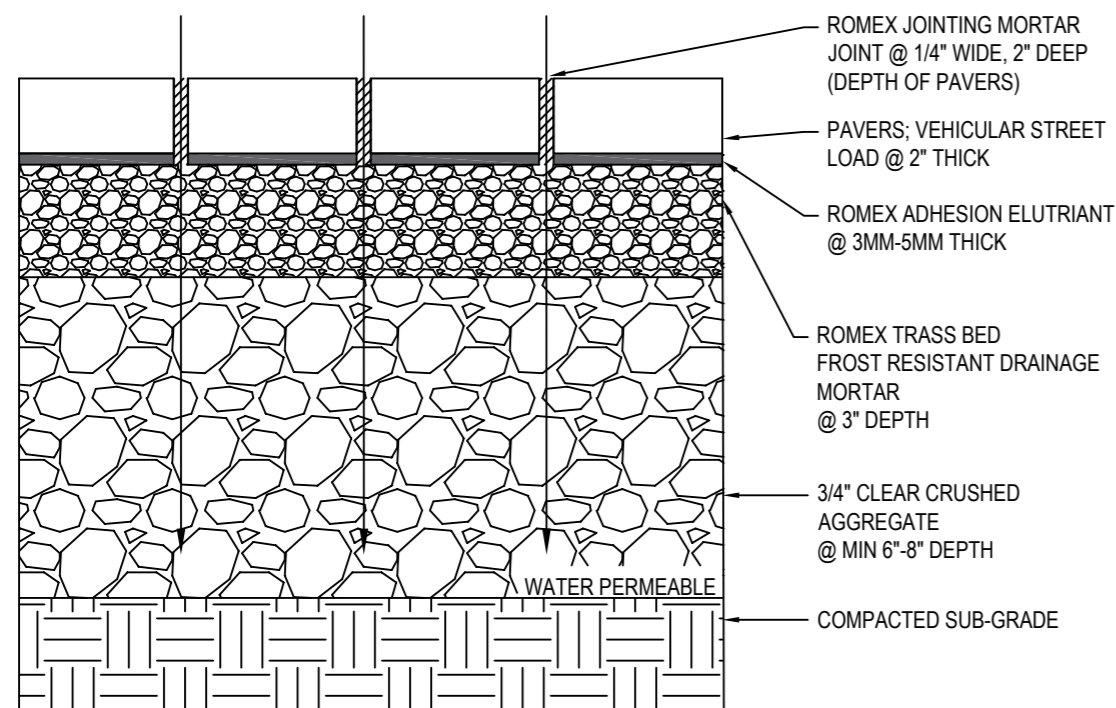

ROMEX® - ADHESION ELUTRIANT:

MIXING: TO ACHIEVE A CONSISTENCY THAT IS PLASTIC AND CAN BE SPREAD, POUR 8.5 LITRES OF COOL, CLEAN WATER INTO A CONTAINER. THEN ADD 25KG OF ROMEX® - ADHESION ELUTRIANT AND STIR FOR 3 MINUTES. AFTER 3 MINUTES OF MATURING TIME STIR THROUGH AGAIN BRIEFLY. ALWAYS USE THE ENTIRE CONTAINER.

APPLICATION: APPLIED TO THE SLAB UNDERSIDE WITH A LAYER THICKNESS OF APPROX. 3-5 MM OR DIP THE SLAB 2-3 CM DEEP INTO THE TUB OF ROMEX® - ADHESION ELUTRIANT.

STORAGE LIFE: 6 MONTHS OF STORAGE LIFE (DRY IN ORIGINAL, SEALED SACK).

ROMEX® - TRASS BED

MIXING: MIX ROMEX® - TRASS BED COMPOUND IN A RATIO OF 1 TO 4 WITH FILLER MATERIAL (I.E ROLLED GRIT / GRAVEL) 4-8MM SO THAT IT IS EARTH DAMP, MIXING TIME 2-3 MINUTES. WATER REQUIREMENTS APPROX 9% (3.6-3.8 LITRES) OF COOL, CLEAN WATER PER 40 KGS OF READY TO USE MIXTURE. IMPORTANT TO ADD WATER TO THE MIXER FIRST, THEN THE MORTAR.

APPLICATION: NATURAL PAVING STONES SHOULD BE 3-6 CM DEPENDING ON TYPE OF STONE AND EXPECTED LOADS. WHEN FILLING THE JOINTS, AT LEAST 3 CM JOINT DEPTH FROM THE TOP OF THE STONE IS REQUIRED, IN CASE OF TRAFFIC LOADS AT LEAST 2/3 OF THE HEIGHT. NATURAL AND CONCRETE STONE SLABS SHOULD BE TREATED WITH ROMEX® - ADHESION ELUTRIANT BEFORE LAYING.

STORAGE LIFE: 6 MONTHS OF STORAGE LIFE (DRY IN ORIGINAL, SEALED SACK).

NOTES:

1. INSTALLATION TO BE COMPLETED IN ACCORDANCE WITH MANUFACTURER'S SPECIFICATIONS.
2. DO NOT SCALE DRAWING.
3. THIS DRAWING IS INTENDED FOR USE BY ARCHITECTS, ENGINEERS, CONTRACTORS, CONSULTANTS AND DESIGN PROFESSIONALS FOR PLANNING PURPOSES ONLY. THIS DRAWING MAY NOT BE USED FOR CONSTRUCTION.
4. ALL INFORMATION CONTAINED HEREIN WAS CURRENT AT THE TIME OF DEVELOPMENT BUT MUST BE REVIEWED AND APPROVED BY THE PRODUCT MANUFACTURER TO BE CONSIDERED ACCURATE.
5. CONTRACTOR'S NOTE: FOR PRODUCT AND COMPANY INFORMATION VISIT www.CADdetails.com/info AND ENTER REFERENCE NUMBER 5315-004

ROMEX® RSG PERMEABLE PAVING SYSTEM

WITH RADIANT HEAT

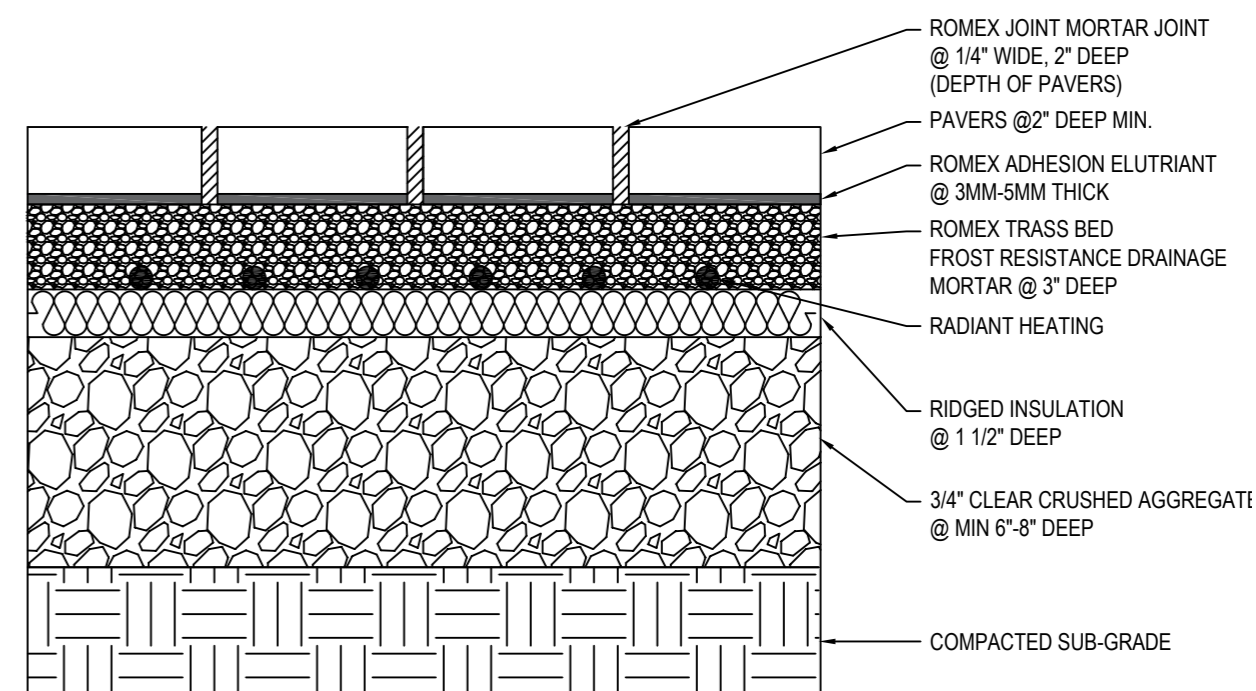

ROMEX® - ADHESION ELUTRIANT:

MIXING: TO ACHIEVE A CONSISTENCY THAT IS PLASTIC AND CAN BE SPREAD, POUR 8.5 LITRES OF COOL, CLEAN WATER INTO A CONTAINER. THEN ADD 25KG OF ROMEX® - ADHESION ELUTRIANT AND STIR FOR 3 MINUTES. AFTER 3 MINUTES OF MATURING TIME STIR THROUGH AGAIN BRIEFLY. ALWAYS USE THE ENTIRE CONTAINER.

APPLICATION: APPLIED TO THE SLAB UNDERSIDE WITH A LAYER THICKNESS OF APPROX. 3-5MM OR DIP THE SLAB 2-3 CM DEEP INTO THE TUB OF ROMEX® - ADHESION ELUTRIANT.

STORAGE LIFE: 6 MONTHS OF STORAGE LIFE (DRY IN ORIGINAL, SEALED SACK).

ROMEX® - TRASS BED

MIXING: MIX ROMEX® - TRASS BED COMPOUND IN A RATIO OF 1 TO 4 WITH FILLER MATERIAL (I.E ROLLED GRIT / GRAVEL) 4-8MM SO THAT IT IS EARTH DAMP, MIXING TIME 2-3 MINUTES. WATER REQUIREMENTS APPROX 9% (3.6-3.8 LITRES) OF COOL, CLEAN WATER PER 40 KGS READY TO USE MIXTURE. IMPORTANT TO ADD WATER TO THE MIXER FIRST, THEN THE MORTAR.

APPLICATION: NATURAL PAVING STONES SHOULD BE 3-6CM DEPENDING ON TYPE OF STONE AND EXPECTED LOADS. WHEN FILLING THE JOINTS, AT LEAST 3 CM JOINT DEPTH FROM THE TOP OF THE STONE IS REQUIRED, IN CASE OF TRAFFIC LOADS AT LEAST 2/3 OF THE HEIGHT. NATURAL AND CONCRETE STONE SLABS SHOULD BE TREATED WITH ROMEX® - ADHESION ELUTRIANT BEFORE LAYING.

STORAGE LIFE: 6 MONTHS OF STORAGE LIFE (DRY IN ORIGINAL, SEALED SACK).

ROMEX® - JOINTING MORTAR

PREPARATION: CLEAN OUT JOINTS TO A DEPTH OF AT LEAST 30MM (MINIMUM JOINT WIDTH 5MM). THE SURFACE TO BE JOINTED SHOULD BE CLEANED OUT OF ALL KINDS OF DIRT. ANY ADJOINING SURFACES THAT ARE NOT TO BE JOINTED SHOULD BE TAPED OFF.

STORAGE LIFE: 12-24 MONTHS.

NOTES:

1. INSTALLATION TO BE COMPLETED IN ACCORDANCE WITH MANUFACTURER'S SPECIFICATIONS.
2. DO NOT SCALE DRAWING.
3. THIS DRAWING IS INTENDED FOR USE BY ARCHITECTS, ENGINEERS, CONTRACTORS, CONSULTANTS AND DESIGN PROFESSIONALS FOR PLANNING PURPOSES ONLY. THIS DRAWING MAY NOT BE USED FOR CONSTRUCTION.
4. ALL INFORMATION CONTAINED HEREIN WAS CURRENT AT THE TIME OF DEVELOPMENT BUT MUST BE REVIEWED AND APPROVED BY THE PRODUCT MANUFACTURER TO BE CONSIDERED ACCURATE.
5. CONTRACTOR'S NOTE: FOR PRODUCT AND COMPANY INFORMATION VISIT www.CADdetails.com/info AND ENTER REFERENCE NUMBER 5315-004



ROMEX® webinars

Learn more about ROMEX® Canada online!
Join one of our interactive webinar sessions to learn more about our range of permeable products, low maintenance solutions and industry leading 10-year warranty.



Register today

<https://romexcanada.com>